

## Current Project Stories related to the book

### Pocket Neighborhoods: Creating Small Scale Community in a Large Scale World

Contact: Kate Loudon at Ross Chapin Architects: [kate@rosschapin.com](mailto:kate@rosschapin.com)

---

#### Inglenook Neighborhood

Carmel, Indiana



This is a project under construction now near Indianapolis. The first phase includes 26 houses oriented around garden courtyards on a suburban site (Wholefoods is a mile away). Full build out of the plan may include approximately 140 homes & townhouses in pocket neighborhood settings, along with community buildings and a local retail/office center.

Developer: Casey Land  
Company: Land Development & Building Co., Inc.  
Email: [mcaseyland@yahoo.com](mailto:mcaseyland@yahoo.com)  
Websites: <http://www.inglenookcarmel.com>  
<http://pocket-neighborhoods.net/examples/large.html>

---

#### Concord Riverwalk

West Concord, Massachusetts



This is another project under construction; RCA was the land planner. The site is an infill location in an old community. Two renovated historic buildings face the street, with 10 cottage homes located behind and around a garden courtyard. There will be a commons structure and community garden.

Developer: Dan Gainsboro  
Company: Genesis Planners, Inc.  
Email: [dgainsboro@genesisplanners.com](mailto:dgainsboro@genesisplanners.com)  
Websites: <http://www.concordriverwalk.com/neighborhood/overview>  
<http://pocket-neighborhoods.net/examples/single2.html>

---

#### Wyers End

White Salmon, Washington



An 18-home pocket neighborhood near a small town center on the Columbia River — completed last year.

Developer: Henry Fischer, Randy Orzeck  
Company: Smart Development Corporation  
Email: [randy@smartdevelopment.com](mailto:randy@smartdevelopment.com)  
Websites: [http://www.smartdevelopment.com/wyers\\_siteplan.cfm](http://www.smartdevelopment.com/wyers_siteplan.cfm)  
<http://www.rosschapin.com/Projects/PocketNeighborhoods/WyersEnd/WyersEnd.html>

---

---

**Squam River Landing**  
Ashland, New Hampshire

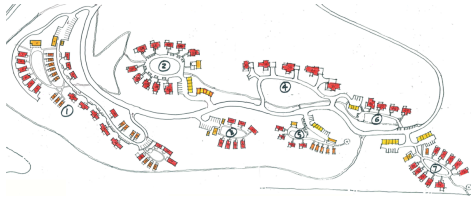

This is a 65-home community “on the boards” in active planning. The site is located on a rural hillside overlooking Squam Lake (where On Golden Pond was filmed). The target market is second homebuyers in the Boston region.

Developer: Barry Gaw  
Company: Sippican Partners, LLC  
Email: bgaw@sippicanpartners.com  
Websites: <http://www.sippican.hollisint.com/projects/squam-river-landing/#>

---

**Holderness Cottages**  
Holderness, New Hampshire



This is a pocket neighborhood of 10 cottages located within the village of Holderness on Squam Lake, currently in early planning stage. The target market for this community is the local workforce and retirees.

Developer: Barry Gaw  
Company: Sippican Partners, LLC  
Email: bgaw@sippicanpartners.com

---

**Sundial Cottages**  
Tukwila, Washington

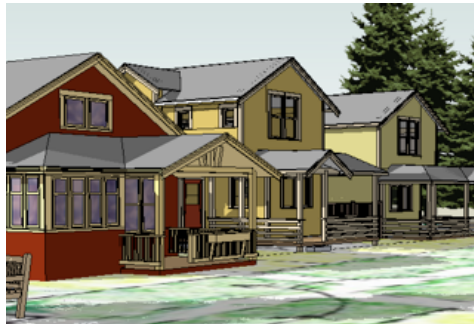

This project is approved and is ready to go — 10 cottages on an infill site near Seatac Airport in Seattle. Target market is one & two-person workforce households.

Developer: Doug Davies  
Company: Sundial Cottages  
Email: douglas.c.davies@boeing.com

---

**Blueberry Cottages**  
Kent, Washington



This is an active project in a city near Seattle moving through permit approvals. It is part of an innovative housing demonstration program with the city to promote housing diversity and affordability.

Developer: JB Ruth  
Company: WE Ruth Real Estate, Inc  
Email: jbruth10@msn.com